

THE COURT BUILDING

Englewood, NJ

The Court Building, located in the epicenter of downtown Englewood, was constructed in the early 1900's. Palisade Avenue and Dean Street are home to the finest boutiques and specialty stores. Some national tenants that have located onto the thriving Avenue include, CVS, Chick-Fil-A, Ben & Jerry's, and Starbucks. The list of national retailers continues at Palisades Court, another Treeco development one block west of the Court Building, with a 79,000 sf ShopRite, Chipotle, Chick-Fil-A, and Apple Bank. Bergen Performing Arts Center, adjacent to Palisades Court, sells over 200,000 tickets annually. Englewood's office space is in excess of 4 million sf. Englewood Hospital is the third largest private hospital in New Jersey. In addition to a large public school system, there are over 3,000 students in attendance from Pre-school through High School in private schools.



treeco



PARKING

MUNICIPAL + STREET SPACES



+5,000

TOTAL SQ FT STREET LEVEL



+6,000

TOTAL SQ FT LOFT LEVEL



153,717

3-MILE POPULATION



\$164,892

3 MI. AVERAGE HH INCOME



3 MILE POPULATION BY AGE

Median Age: 41

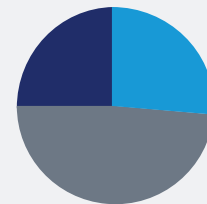

Under age 25

Age 25-54

Age 55+



LOCATION

Palisade Avenue and Dean Street
Englewood, NJ



REGIONAL ACCESS

Routes 4, 17 and 80
Palisade Interstate Pkwy
New Jersey Turnpike



DESCRIPTION

Downtown Retail

AREA STORES:



10 East Palisade Avenue, Englewood, NJ 07631 | TEL: 201-871-8800 x 221 | FAX: 201-871-4081 | afish@treecocenters.com

treecocenters.com

THE COURT BUILDING

Englewood, NJ

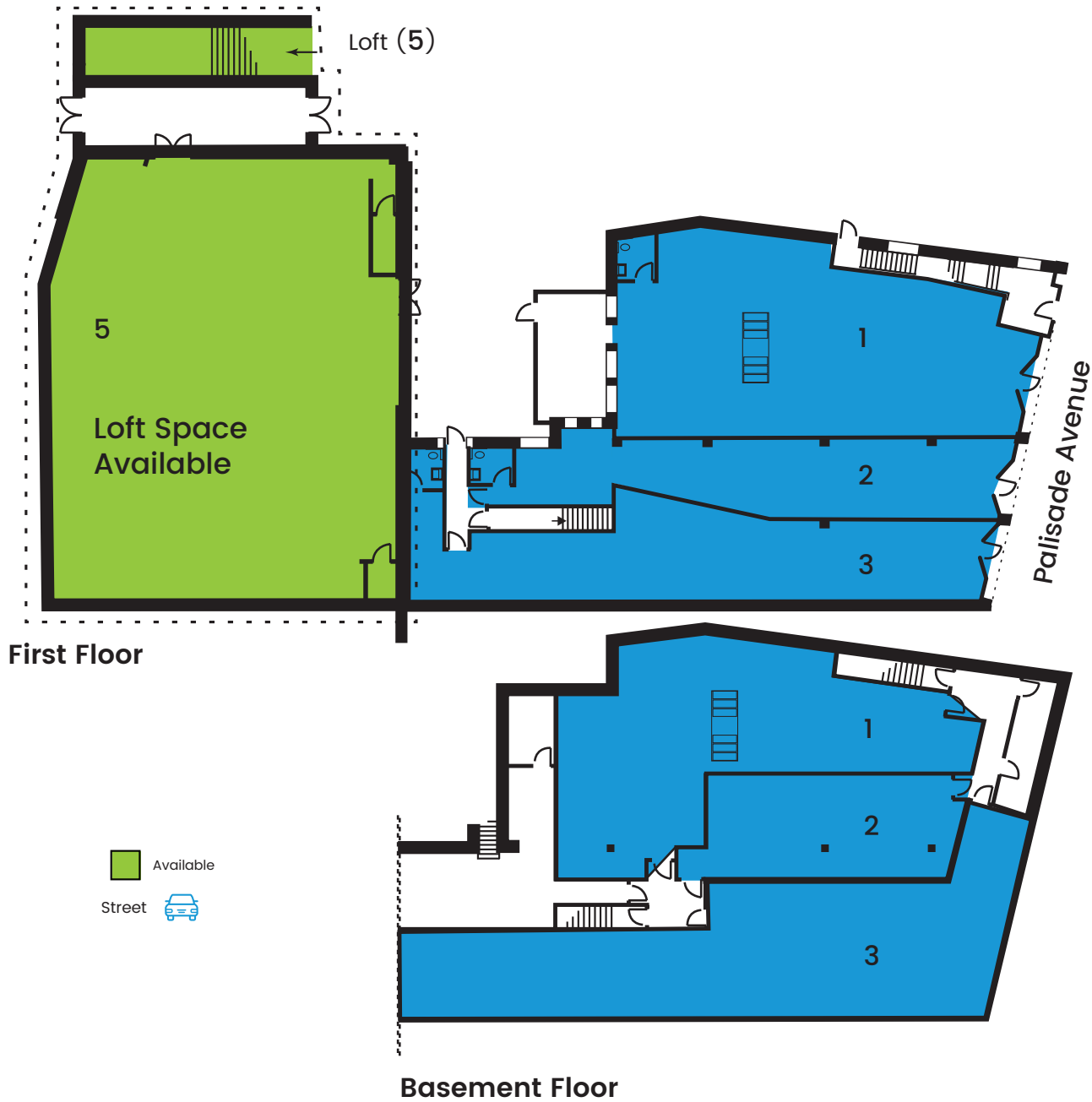

1ST FLOOR

1. Woof Gang	2,000 sf
2. OTA	1,300 sf
3. European Wax Center	1,800 sf
4. The Change Company	2,400 sf

2ND FLOOR

5. Available	2,500 sf
--------------	----------